

The Intermec logo features the word "Intermec" in a bold, italicized, sans-serif font. To the right of the text is a square icon containing a stylized white circle with a smaller circle inside it, resembling a target or a lens.

**Intermec**

A decorative graphic consisting of several overlapping, light gray circles and arcs, creating a sense of motion or a stylized orbit. A vertical line extends from the bottom of the square icon in the Intermec logo down towards the bottom of the page.

## Installation Instructions

### **Cutter Kit**

(for EasyCoder PX4i,  
PX6i, 501 XP, and  
601 XP printers)

Intermec Technologies Corporation  
Corporate Headquarters  
6001 36th Ave. W.  
Everett, WA 98203  
U.S.A.  
[www.intermec.com](http://www.intermec.com)

The information contained herein is proprietary and is provided solely for the purpose of allowing customers to operate and service Intermec-manufactured equipment and is not to be released, reproduced, or used for any other purpose without written permission of Intermec.

Information and specifications contained in this document are subject to change without prior notice and do not represent a commitment on the part of Intermec Technologies Corporation.

© 2004 by Intermec Technologies Corporation. All rights reserved.

The word Intermec, the Intermec logo, Norand, ArciTech, CrossBar, Data Collection Browser, dcBrowser, Duratherm, EasyCoder, EasyLAN, Enterprise Wireless LAN, EZBuilder, Fingerprint, i-gistics, INCA (under license), InterDriver, Intermec Printer Network Manager, IRL, JANUS, LabelShop, Mobile Framework, MobileLAN, Nor\*Ware, Pen\*Key, Precision Print, PrintSet, RoutePower, TE 2000, Trakker Antares, UAP, Universal Access Point, and Virtual Wedge are either trademarks or registered trademarks of Intermec Technologies Corporation.

Throughout this manual, trademarked names may be used. Rather than put a trademark (™ or ®) symbol in every occurrence of a trademarked name, we state that we are using the names only in an editorial fashion, and to the benefit of the trademark owner, with no intention of infringement.

There are U.S. and foreign patents pending.

Torx is a registered trademark of Camcar Division of Textron Inc.

# Contents

<b>1</b>	<b>Introduction</b>	
	Description.....	2
<b>2</b>	<b>Installation</b>	
	Step-by-step instructions.....	6
<b>3</b>	<b>Controlling the Cutter</b>	
	Fingerprint.....	10
	IPL.....	10
<b>4</b>	<b>Maintenance and Troubleshooting</b>	
	Cleaning.....	12

**Contents**



# 1 Introduction

This chapter describes the cutter kits for EasyCoder PX4i, PX6i, 501 XP, and 601 XP printers.

## Description

The EasyCoder PX4i/PX6i and 501 XP/601 XP printers can easily be fitted with an optional cutter, provided the printer is not already fitted with an label-taken sensor. The cutters are almost identical with exception for the width. Illustrations in this manual show EasyCoder PX4i/PX6i printers, but the same principles apply to EasyCoder 501 XP/601 XP printers.

The cutter supports both Intermec Fingerprint and IPL.

The cutter unit is fitted on the same hinges as the front door, which it replaces, and is connected by a single cable to the DIN-connector on the printer's front.

The cutter is available both as a factory-installed option and as a field-installable upgrading kit. It can be installed by the operator.

The cutter is intended to cut through continuous non-adhesive paper strip or through the backing paper between labels. It must not be used to cut through any kind of adhesive or other soft material, that may stick to the cutting parts and render the cutter inoperable and even damage the electric motor by overheating.

Maximum paper thickness is 175  $\mu\text{m}$  ( $\approx$  175 grams/m<sup>2</sup>) for normal paper-based materials.

Minimum practical copy length is 38.1 mm (1.5 inches)

The cutter increases the printer's total weight and length as follows:

### EasyCoder PX4i/501 XP:

Weight:	1.0 kg	(2.2 lbs)
Length:	28 mm	(1.1 inches)

### EasyCoder PX6i/601 XP:

Weight:	1.65 kg	(3.6 lbs)
Length:	28 mm	(1.1 inches)

The cutter can be tilted forward in order to facilitate cleaning and paper load.



Warning

**The cutting edge will rotate to home position when the power is turned on and when the printer is rebooted. Always keep the cutter unit closed during operation.**

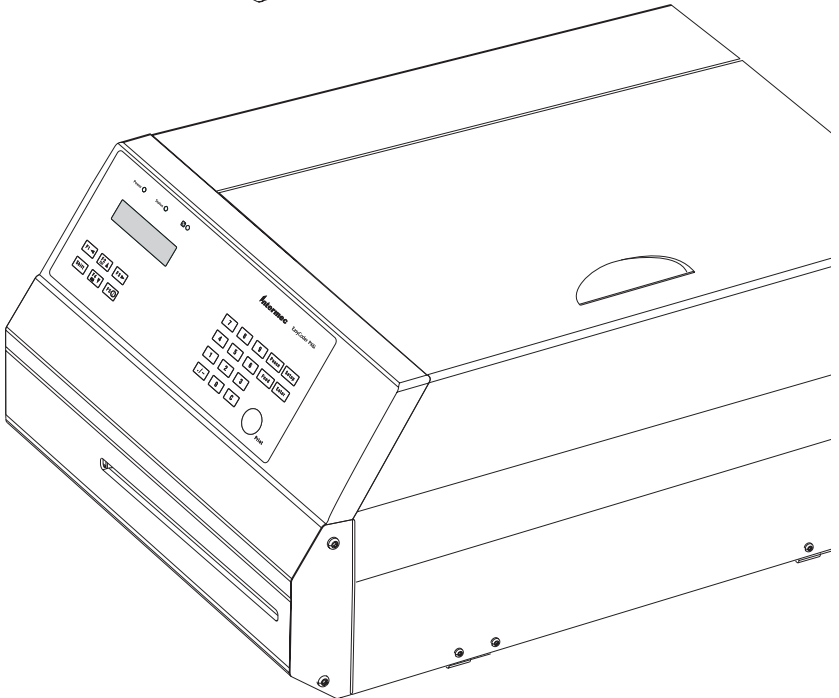
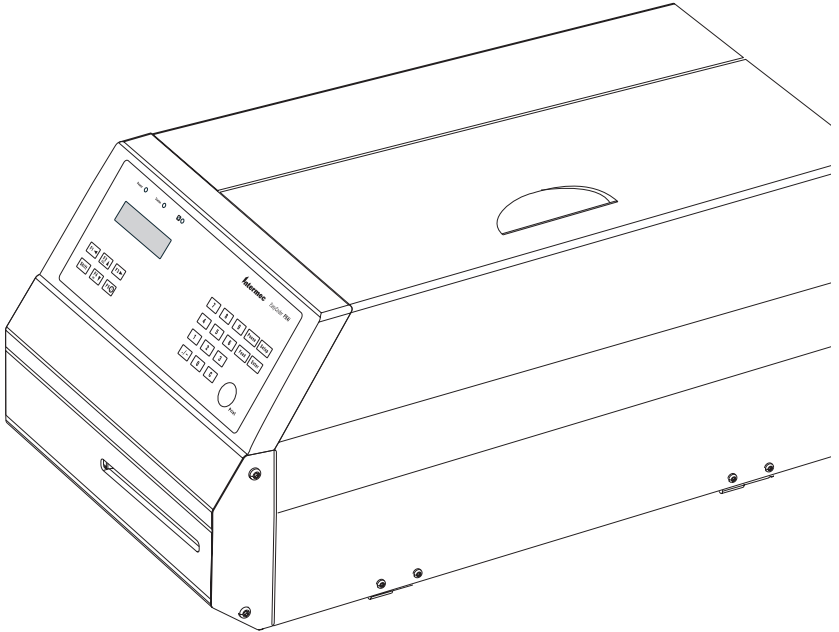



A decorative graphic consisting of two overlapping circles. The larger circle is light gray and partially encloses the smaller circle. The smaller circle is also light gray and has a small dark gray dot at its rightmost point.

# **2** Installation

This chapter describes how to install the cutter on an EasyCoder PX4i/PX6i or 501 XP/601 XP printer. No tools are required.

## Chapter 2 — Installation

Install the cutter as follows:

- Switch off the power and remove the power cord.
- Open the printer's front door.
- Hold the printer firmly and press the front door sideways to the left so as to disengage the hinges.
- Remove the door completely.

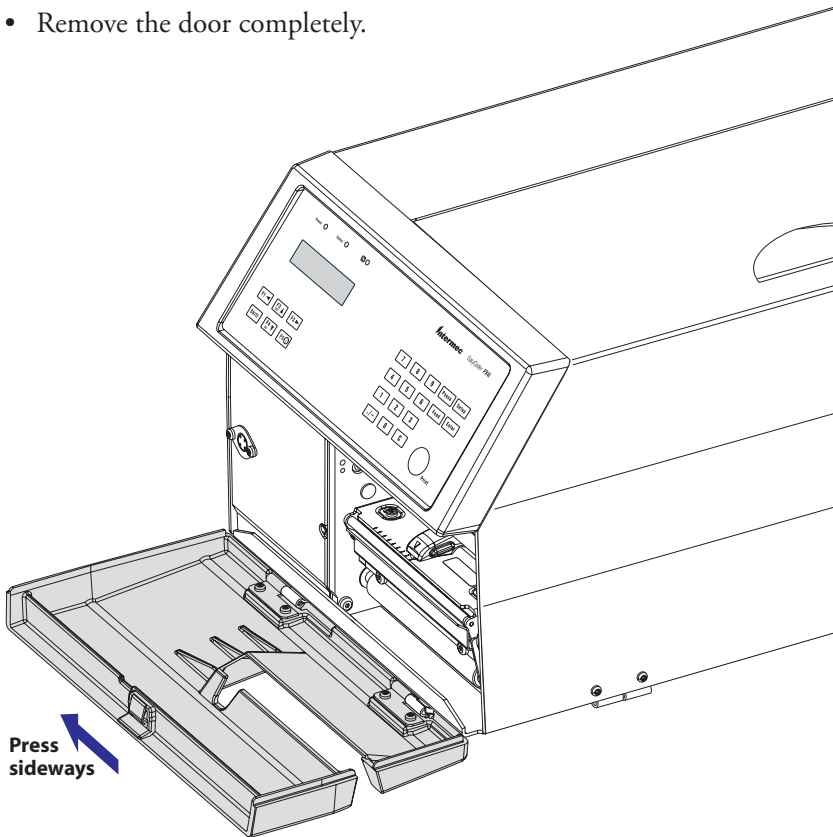

- Fit the cutter unit to the vacant hinges. Make sure that the locking plate snaps into the groove of the right-hand hinge and that the angled plate at the bottom of the cutter is inserted under the printer's bottom plate.
- Fit the cable from the cutter unit into the DIN connector on the printer's front.

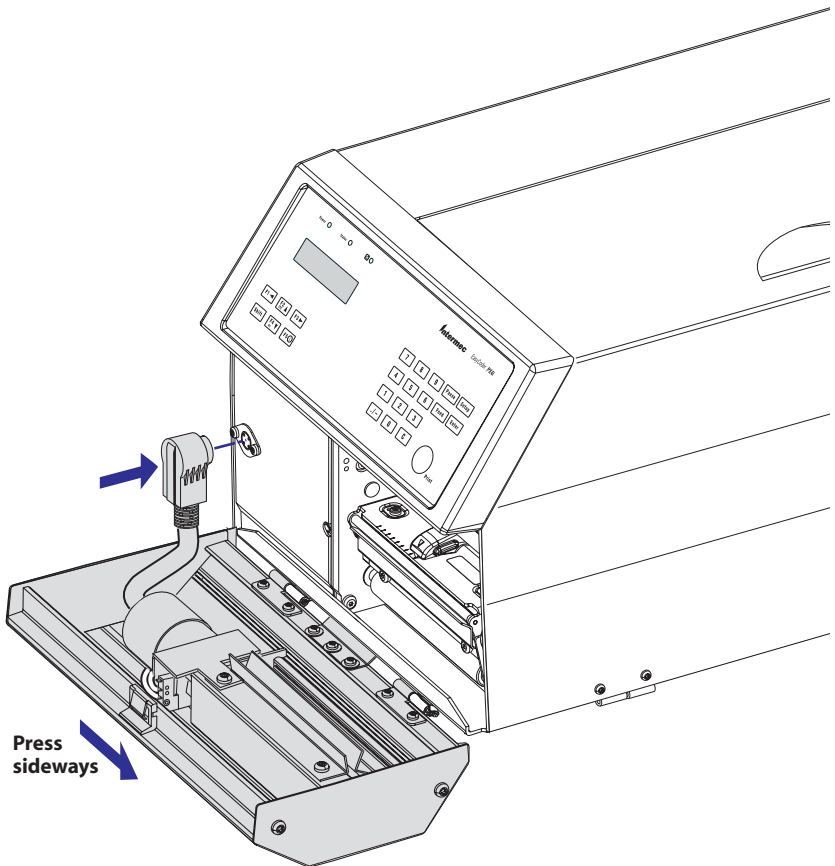

- Tilt the cutter unit upwards until it locks into place. If the cutter does not lock properly, the hinges of the cutter unit may need to be adjusted using a #T10 Torx screwdriver.
- Put back the power cord and switch on power. The cutter will perform an idle cycle in order to occupy its home position.
- Switch off the power. Tilt down the cutter and route the paper through the cutter unit between the guide plates (also see the *User's Guide* for the printer in question). Then tilt up the cutter again and lock it in closed position.
- Check that the printhead is lowered and switch on the power. Now the printer is ready for operation.

**Chapter 2 — Installation**

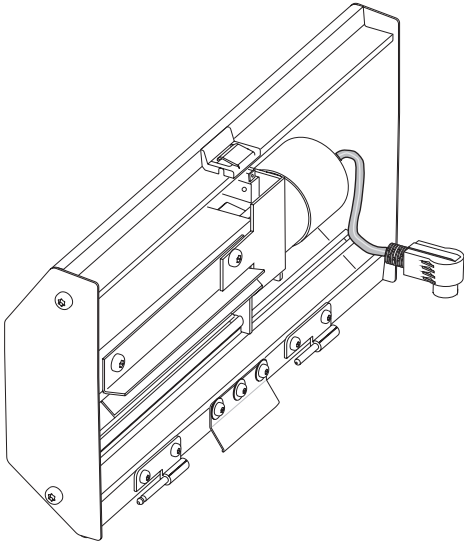

*EasyCoder PX4i/501 XP Cutter*

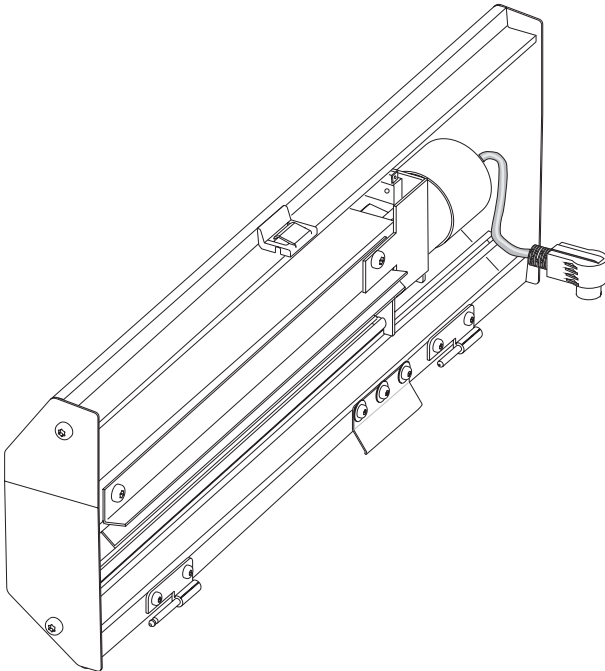

*EasyCoder PX6i/601 XP Cutter*

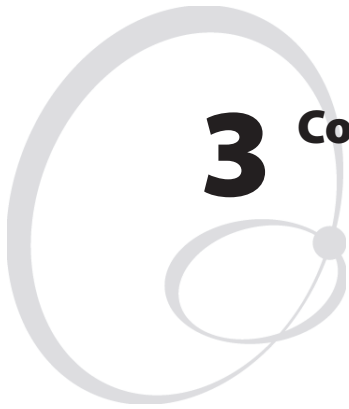

## **3** Controlling the Cutter

This chapter describes how the cutter is controlled using Intermec Fingerprint or IPL.

## Fingerprint

The cutter is activated by CUT or CUT ON statements, see the *Intermec Fingerprint Programmer's Reference Manual*, or the *Intermec Direct Protocol Programmer's Reference Manual*. Application programs may have related facilities for operating the cutter.

The edge will cut through the media approx. 37 mm (1.5 inches) in front of the printer's dot line. The following values are recommended for cutting:

Type of Cutting	8 dots/mm printhead	11.81 dots/mm printhead
Cut between labels w. gaps		
Start adjust:	- 287 dots	- 424 dots
Stop adjust:	+ 176 dots	+ 260 dots
Cut fix and variable length strip (no liner!)		
Start adjust:	- 294 dots	- 434 dots
Stop adjust:	+ 298 dots	+ 440 dots

## IPL

The cutter can be enabled/disabled in the Configuration part of the setup mode or using the command <STX><SI>Cn<ETX>, where n= 0 disables the cutter and n=1 enables it. When the cutter is enabled, the media feed is automatically adjusted for cut-off operation.

When the cutter is not enabled, a cut operation (advance label and cut) can be executed using the command <STX><SO><ETX>.

Also see *IPL Programming, Reference Manual*.



## **4** Maintenance and Troubleshooting

This chapter describes how to troubleshoot and clean the cutter.

## Cleaning

The cutter mechanism becomes accessible when the cover is opened.

The cutter shears will need to be cleaned from adhesive residue if the cutter has been used for cutting through labels, something that is not advisable. Use isopropyl alcohol (see warning text on the container), but be careful only to apply it where there is any adhesive residue so you do not dissolve the lubrication.

Do not force the spring-loaded anvil blade open more than 5-10 mm (0.2–0.4 inches), or the spring may be damaged.



Warning

**Switch off the power or disconnect the cutter before cleaning. Keep fingers away from cutting parts!**

### Fingerprint only

If the following errors occur, clean the shears from adhesive residue.

- 1701 “*Cutter error1*”  
A cut has been performed but the shear has stopped on its way back to home (bottom) position.
- 1702 “*Cutter error2*”  
The cutter has failed to cut after several attempt (3 is default) and the shear has returned to home (bottom) position.
- 1703 “*Cutter error3*”  
The cutter has failed to cut and the shear has stopped before returning to home (bottom) position.

If the cutter cable connector has come loose from DIN connector, Error 37, “*Cutter device not found*” or Error 1059, “*Cutter does not respond*” will occur.

If the microswitch in the cutter assy is faulty, Error 1704, “*Cutter open*” will occur, even if the cutter in fact is closed. Contact Service.

### IPL only

IPL reports if the cutter has failed to return to home position by displaying the message “*Open&shut cutter.*” Follow that instruction. If the error persists, clean the shears from adhesive residue. If this does not help, contact Service.









**Intermec Technologies Corporation**

Corporate Headquarters  
6001 36th Avenue West  
Everett, WA 98203

**tel** 425.348.2600

**fax** 425.355.9551

[www.intermec.com](http://www.intermec.com)

EasyCoder PX4/6i & 501/601XP Cutter Kit Installation Instructions



\*1-960631-00\*